

Kelin polyurea tile grout is a new overturning product. Due to POLYUREA's excellent wear-resistance, corrosion-resistance, yellow-resistance, high temperature resistance and other superior performance, it is widely used in the military industry, aerospace and vessels industry. In addition, it solidifies quickly, construction and clean edge in the same day, save time and labor costs. More importantly, it can be constructed in wet subbase surface, which greatly solves the problem that cannot construct because of climate and other reasons. Australia joint research and development products to make the better performance, and through the Chinese Academy of Sciences strategic quality control guidance, to make products' quality stable.

<b>Main Ingredient</b>	Polyurea, High-end color powder
<b>Function</b>	The filling and beautification of tile gap
<b>Shelf Life</b>	Stock in a cool and dry place at 0-37 °C for 8 months
<b>Net Weight</b>	450 ML
<b>Packing</b>	30 Sets/Carton

Our product is totally polyure basic product, can be better used in the joints of ceramic tile, stone, glass, mosaic tile on the wall or flour indoor & outdoor. It has its own special characteristics: permanent moisture proof, more environmental, curing fast, save labor and never discolor, which is its biggest advantage. Welcome to contact Kelin [China flexible tile grout factory](#) for more details.



**Varieties of colors for your choice. Also provide custom colors.**

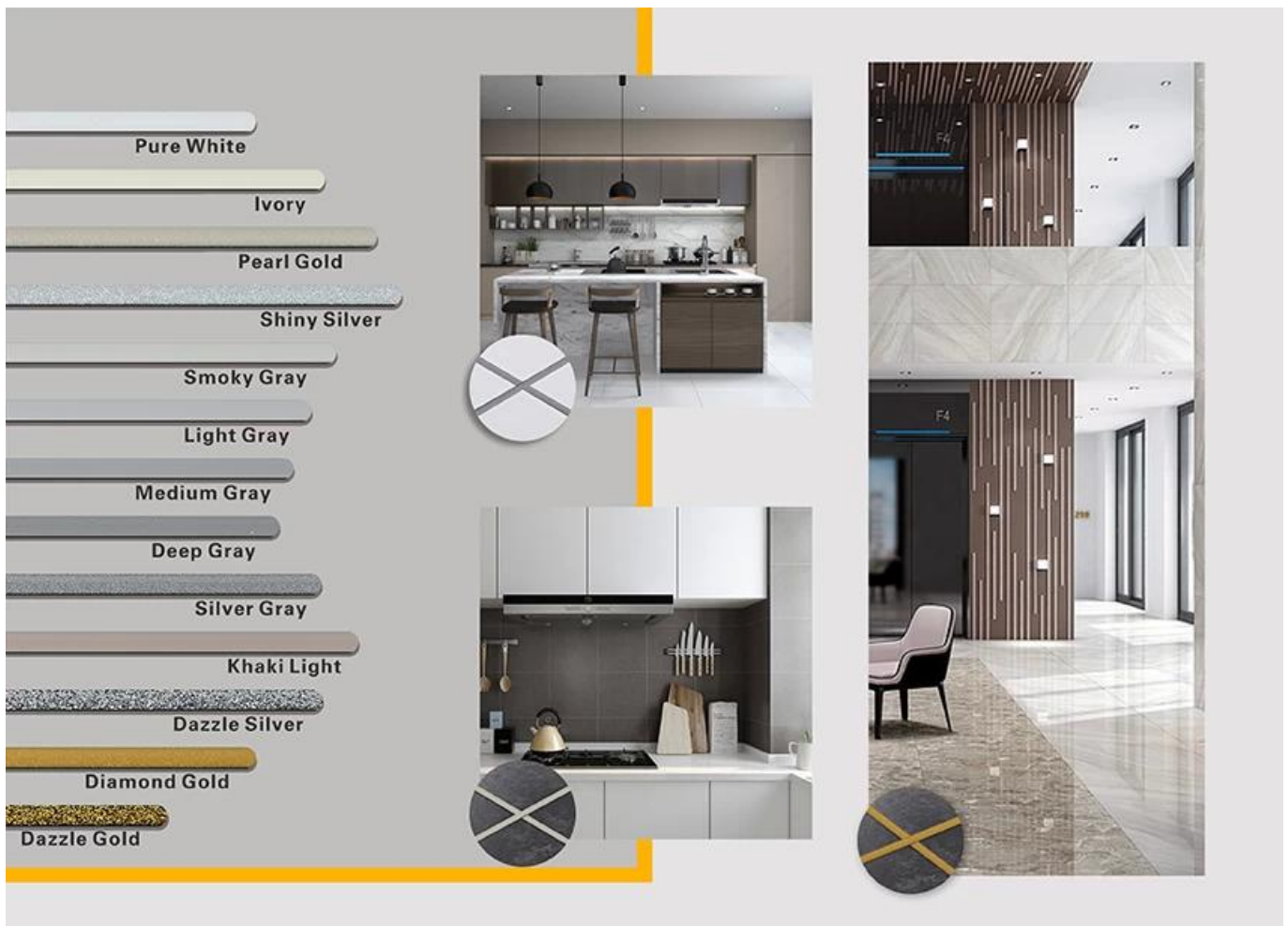

**Provide Whole Room Gap Solution**

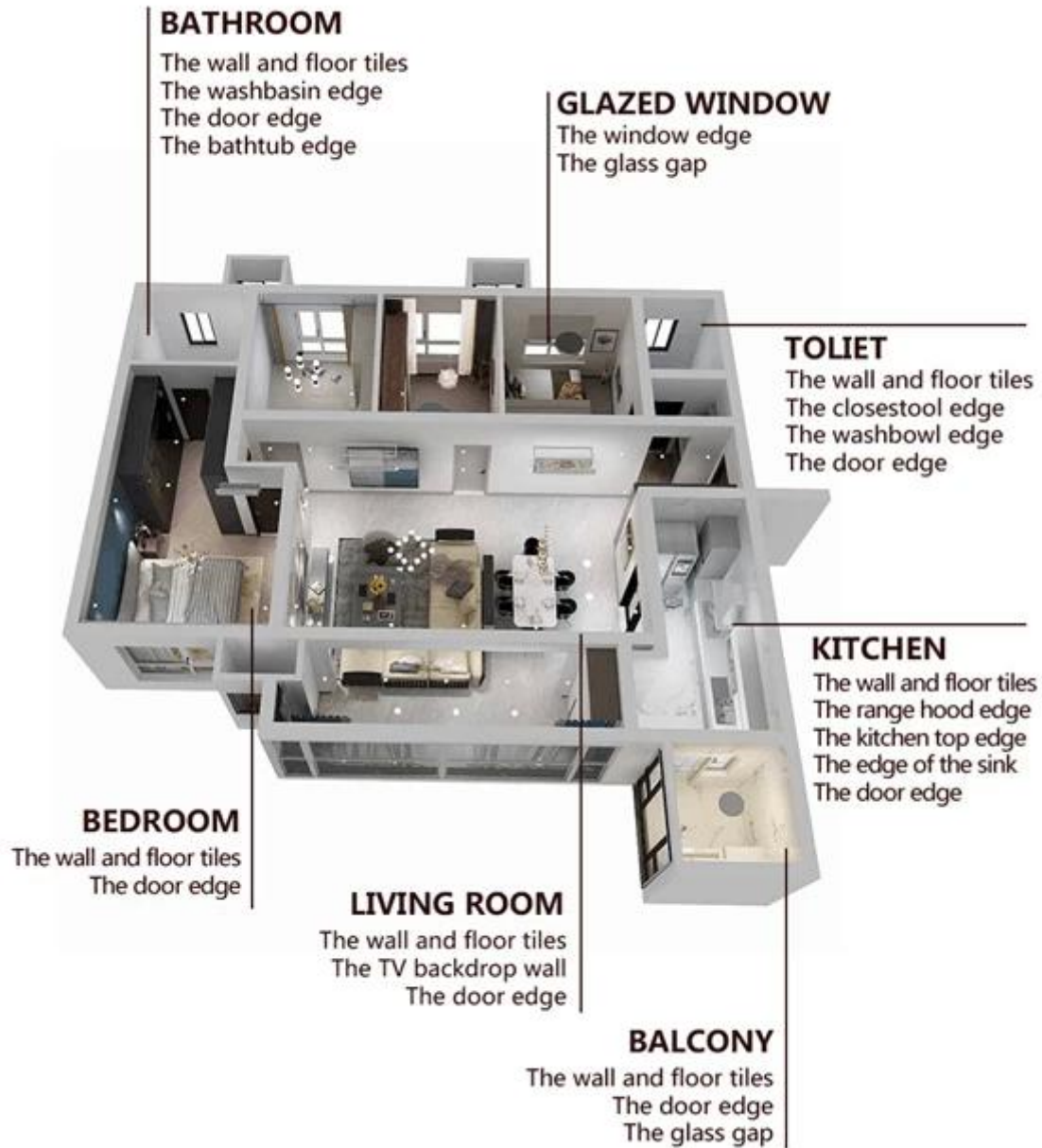

### Brief Construction Process



Clean the tiles and keep it dry.



Polish with tile wax except the glazed tile.



Open & Watch, both sides can extruded meanwhile.



Screw on the nozzle, put on the grout gun.



Inclined cut the top of the nozzle in 45°.



Squeeze out 60-80cm long grout in the forepart.



Evenly squeeze out the tile agent along the gap.

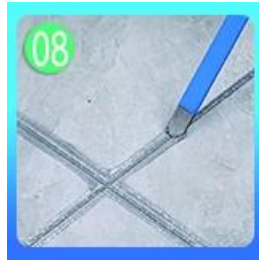

Press the grout with professional glue-press tools.



Don't touch in 2-4 hours and remove excess grout then.



Keep the tiles dry in 24 hours.

## Professional Joint-Pressing Tool



Two Component Caulking Gun



Cutter Knife



Pointing trowel



Brush



Forming Stick



Perching Knife



Masking Tape



Stainless Steel Ball



Cleaning Awl

## Company Advantage





## Factory Overview



Creaming Machine Line



Testing Machine



Batching Production Line



Cooling Filing



Filling Machine Line



Film-coated Machine



Real Material Stock



Stock

## Certification

