

Kelin polyurea tile grout is a new overturning product. Due to POLYUREA's excellent wear-resistance, corrosion-resistance, yellow-resistance, high temperature resistance and other superior performance, it is widely used in the military industry, aerospace and vessels industry. In addition, it solidifies quickly, construction and clean edge in the same day, save time and labor costs. More importantly, it can be constructed in wet subbase surface, which greatly solves the problem that cannot construct because of climate and other reasons. Australia joint research and development products to make the better performance, and through the Chinese Academy of Sciences strategic quality control guidance, to make products' quality stable.

The product of [China gap filling adhesive manufacturer](#) can be better used in the joints of ceramic tile, stone, glass, mosaic tile on the wall or flour in bathroom, kitchen, bedroom and so on. China [Kelin grout for tiles wholesaler](#) has been in this field for 14 years. We have our own R&D team and factory. Because material environmental protection is easy construction, get broad consumer favor. So [Kelin tile grouting material supplier](#) will provide you with quality products. Welcome to contact [China sealant fix super glue factory](#) when you need.



Varieties of colors for your choice. Also provide custom colors.

- Gray 1#
- Gray 2#
- Gray 3#
- Gray 4#
- Gray 5#
- Gray 6#
- Gray 7#
- Gray 8#
- Gray 9#
- Cement Gray
- Dull Gray
- Silver Gray
- Metal Gray
- Luxury Silver
- Glacier White
- Calaeatta
- Pearl Gold
- Slate Gray
- Terra Brown
- Greyish Green
- Yellow Gray
- Soft Khaki
- Yellowish Brown
- Olive Brown
- Brownness
- Dark Brown
- Reddish Brown
- Rock Bslack



Provide Whole Room Gap Solution

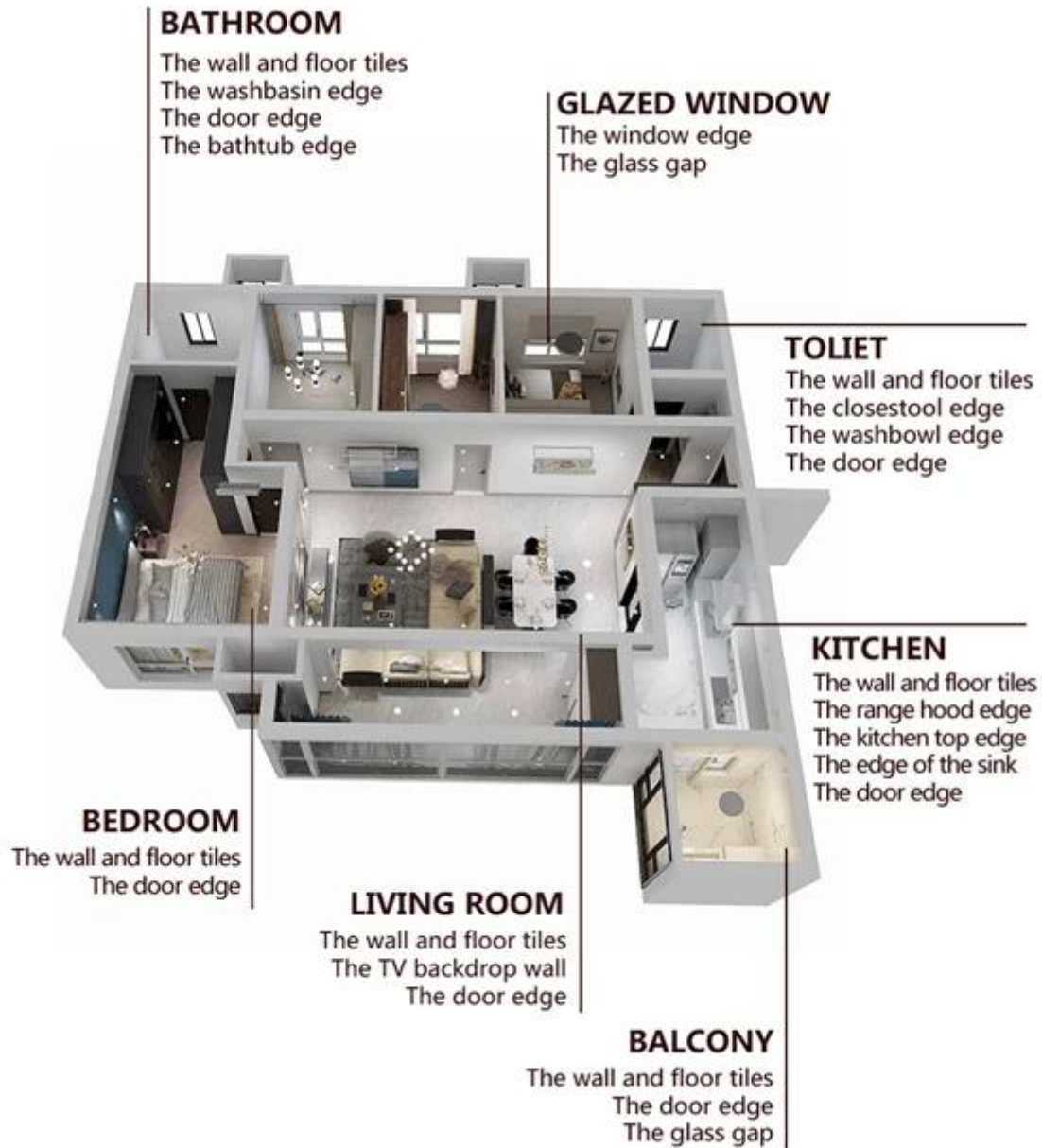

Brief Construction Process

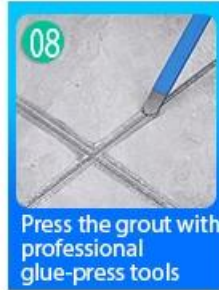
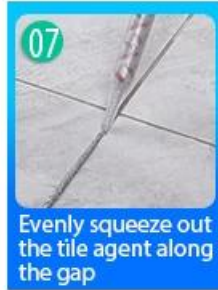
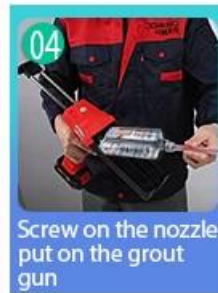
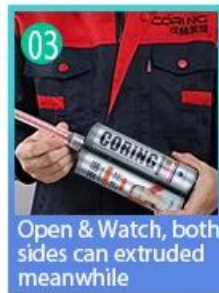

Professional Joint-Pressing Tool



Company Advantage



Factory Overview



Creaming Machine Line



Testing Machine



Batching Production Line



Cooling Filling



Filling Machine Line



Film-coated Machine



Real Material Stock



Stock

Certification

