

Kelin epoxy tile joints adhesive is a new upgraded product after colorful waterborne epoxy tile grout, it not only retains the texture of colorful waterborne epoxy tile grout, upgrades the product performance, but also makes construction easier and more convenient. Soft texture, greatly shows your low-key luxury decorative style. Varieties of colors, make your decoration place sparkling. Eco-friendly epoxy resin subbase course let your product more waterproof, wear-resistant, mould proof and moisture proof. Natural sand calcined at high temperature makes the color more natural and beautiful and never fades. Also, it is as bright as porcelain after cluing without yellowing or decolorizing. In addition, the joint surface looks perfect fit to the ceramic tile, just like nature itself.

Main Ingredient	Epoxy resin, High-end color powder
Function	The filling and beautification of tile gap
Shelf Life	Stock in a cool and dry place at 0-37 °C for 12 months
Net Weight	450 ML
Packing	30 Sets/Carton

The product can be better used in the joints of ceramic tile, stone, glass, mosaic tile on the wall or floor in bathroom, kitchen, bedroom and so on. Australia joint research and development products to make the better performance, and through the Chinese Academy of Sciences strategic quality control guidance, to make products' quality stable. Kelin [grout manufacturer](#) to provide you with quality products.



Varieties of colors for your choice. Also provide custom colors.

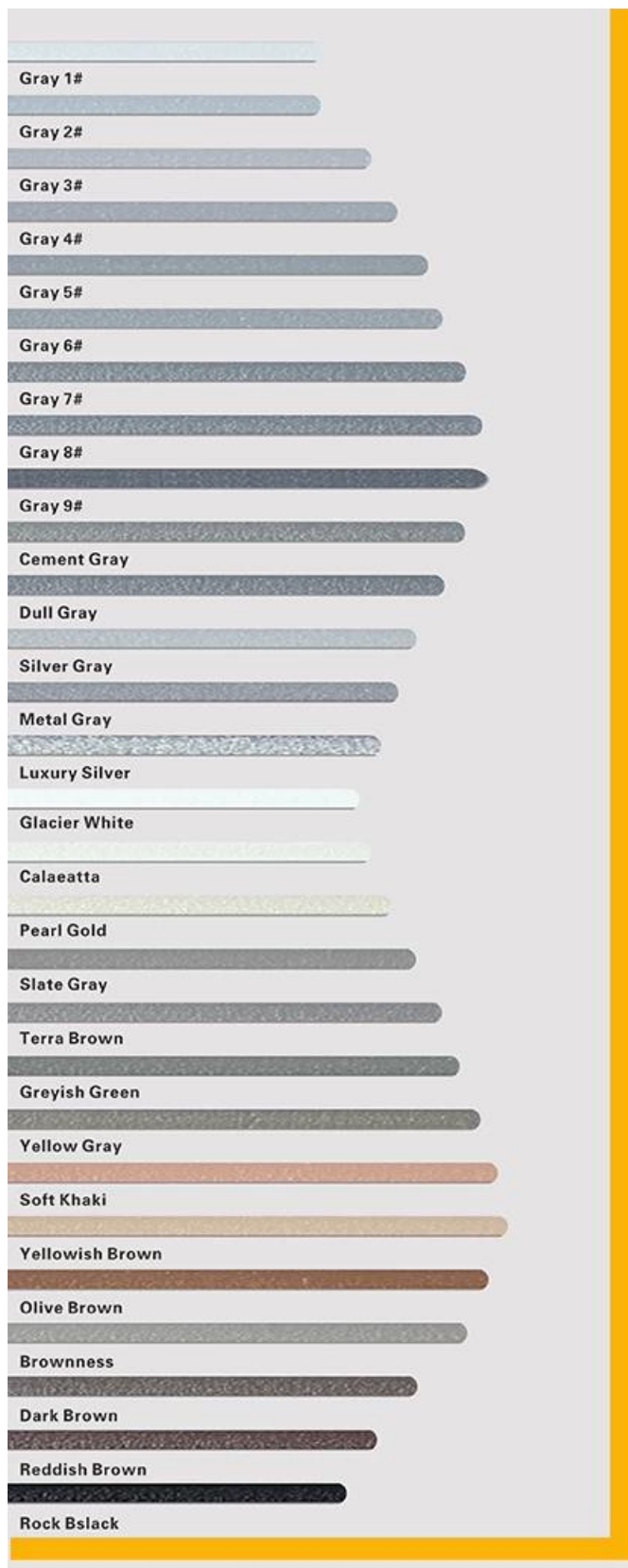

Provide Whole Room Gap Solution

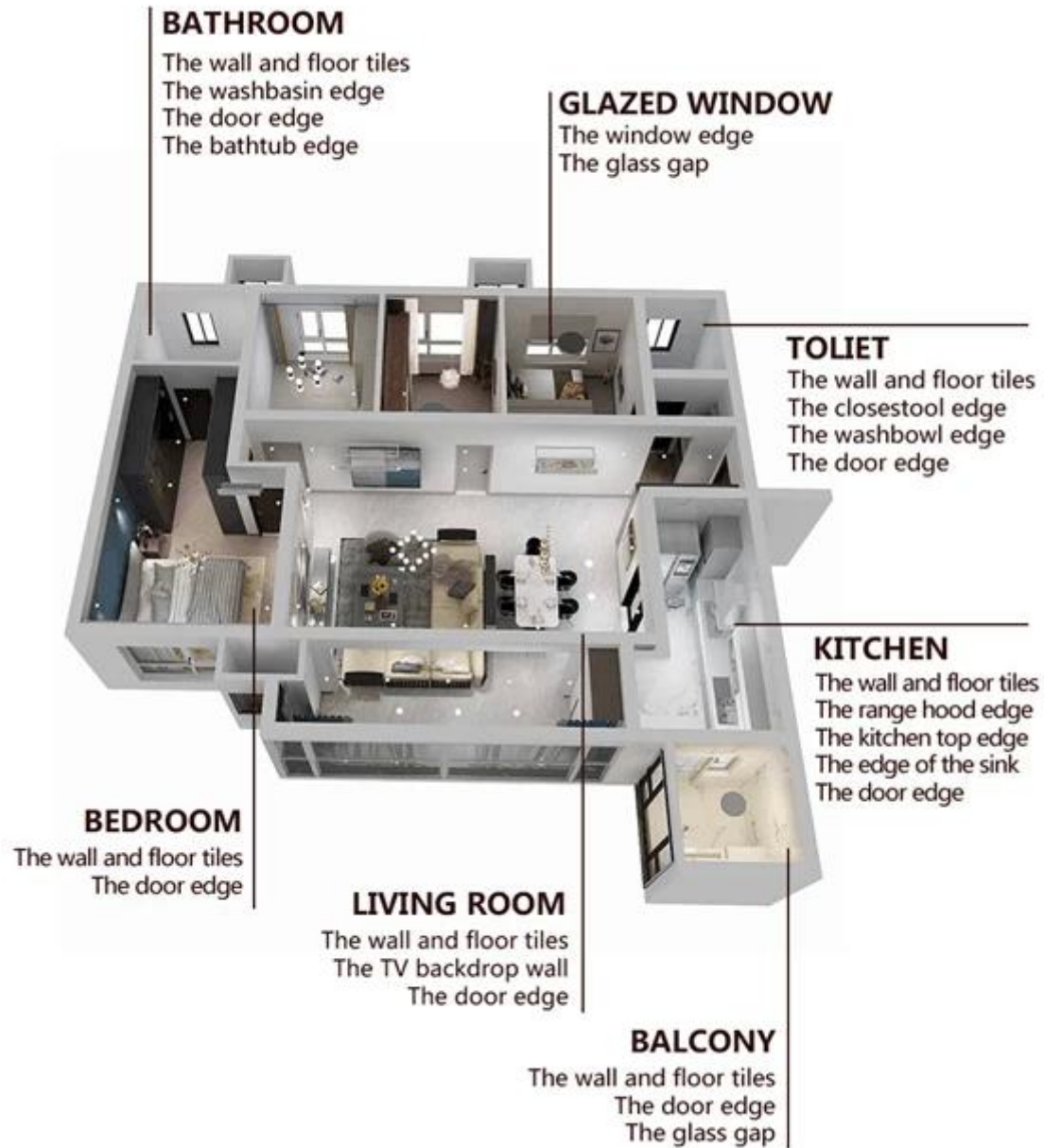

Brief Construction Process



Clean the tiles and keep it dry.

Polish with tile wax except the glazed tile.

Open & Watch, both sides can extruded meanwhile.

Screw on the nozzle, put on the grout gun.

Inclined cut the top of the nozzle in 45°.



Squeeze out 60-80cm long grout in the forepart.

Evenly squeeze out the tile agent along the gap.

Press the grout with professional glue-press tools.

Don't touch in 4-5 hours and remove excess grout then.

Keep the tiles dry in 24 hours.

Professional Joint-Pressing Tool

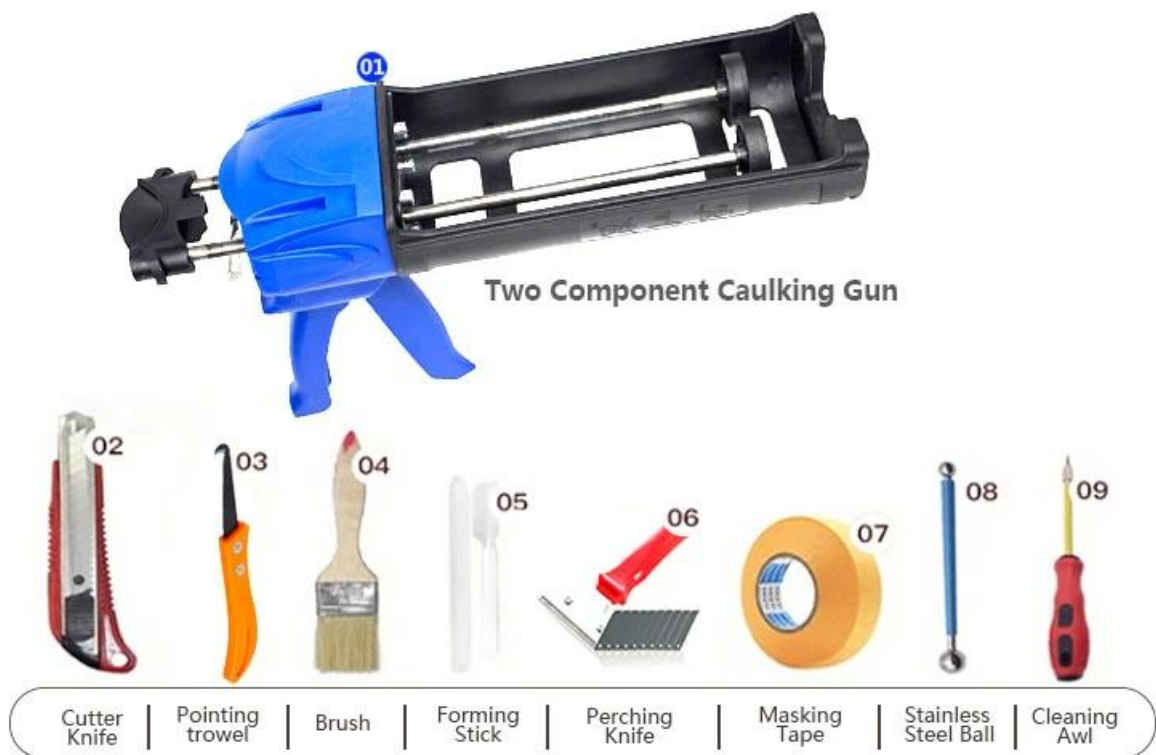

Company Advantage



Factory Overview



Creaming Machine Line



Testing Machine



Batching Production Line



Cooling Filing



Filling Machine Line



Film-coated Machine



Real Material Stock



Stock

Certification

