

Kelin waterborne epoxy adhesive is a high-end environmental product. And we are a tile adhesive supplier with strong comprehensive strength. Matte texture, provides you a low-key luxury decorative style, and the joint surface looks perfect fit to the ceramic tile. Varieties of colors, let your decoration place sparkling. The subbase course of waterborne epoxy resin makes the product absolutely environmental. Natural sand calcined at high temperature makes the color more natural and beautiful and never fades.

The product of [China tile adhesive manufacturer](#) can be better used in the joints of ceramic tile, stone, glass, mosaic tile on the wall or floor in bathroom, kitchen, bedroom and so on. It is a preference product in family decoration, adding negative oxygen ion to purify air. Australia joint research and development products to make the better performance, and through the Chinese Academy of Sciences strategic quality control guidance, to make products' quality stable. Welcome to contact us-[China beauty seam agent supplier](#) cooperation.



Varieties of colors for your choice. Also provide custom colors.

- Gray 1#
- Gray 2#
- Gray 3#
- Gray 4#
- Gray 5#
- Gray 6#
- Gray 7#
- Gray 8#
- Gray 9#
- Cement Gray
- Dull Gray
- Silver Gray
- Metal Gray
- Luxury Silver
- Glacier White
- Calaeatta
- Pearl Gold
- Slate Gray
- Terra Brown
- Greyish Green
- Yellow Gray
- Soft Khaki
- Yellowish Brown
- Olive Brown
- Brownness
- Dark Brown
- Reddish Brown
- Rock Bslack



Provide Whole Room Gap Solution

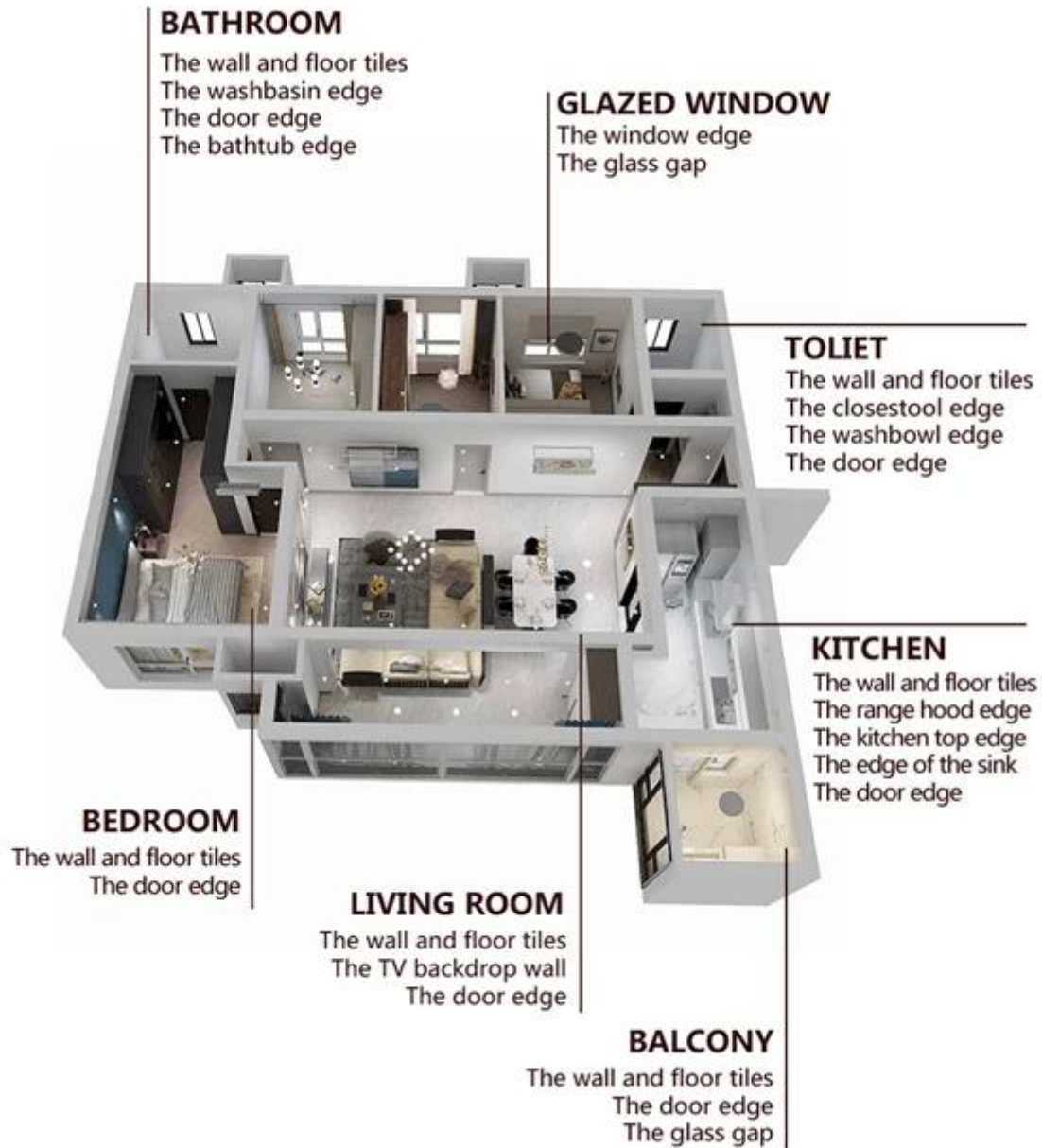

Brief Construction Process



01
Clean the tiles and keep it dry



02
Polish with tile wax except the glazed tile



03
Open & Watch, both sides can extruded meanwhile



04
Screw on the nozzle, put on the grout gun



05
Inclined cut the top of the nozzle in 45°



06
Squeeze out 60-80cm long grout in the forefront



07
Evenly squeeze out the tile agent along the gap

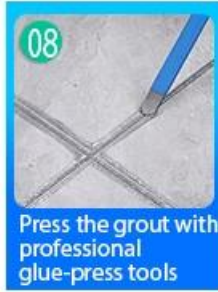

08
Press the grout with professional glue-press tools



09
Don't touch in 4-5 hours and remove excess grout then.

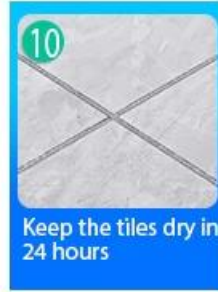

10
Keep the tiles dry in 24 hours

Professional Joint-Pressing Tool



01
Cutter Knife



02
Pointing trowel



03
Brush



04
Rainbow Scraper



05
Stirring Knife



06
The sponge



07
Scouring Pad

Company Advantage



Factory Overview



Creaming Machine Line



Testing Machine



Batching Production Line



Cooling Filling



Filling Machine Line



Film-coated Machine



Real Material Stock



Stock

Certification

