

Kelin waterborne epoxy adhesive is a high-end environmental product. And we are a tile grout manufacturer with strong comprehensive strength. Matte texture, provides you a low-key luxury decorative style, and the joint surface looks perfect fit to the ceramic tile. Varieties of colors, let your decoration place sparkling. The subbase course of waterborne epoxy resin makes the product absolutely environmental. Natural sand calcined at high temperature makes the color more natural and beautiful and never fades. The product of [China epoxy tile grout manufacturer](#) can be better used in the joints of ceramic tile, stone, glass, mosaic tile on the wall or floor in bathroom, kitchen, bedroom and so on. It is a preference product in family decoration, adding negative oxygen ion to purify air. Australia joint research and development products to make the better performance, and through the Chinese Academy of Sciences strategic quality control guidance, to make products' quality stable.



Varieties of colors for your choice. Also provide custom colors.



Provide Whole Room Gap Solution

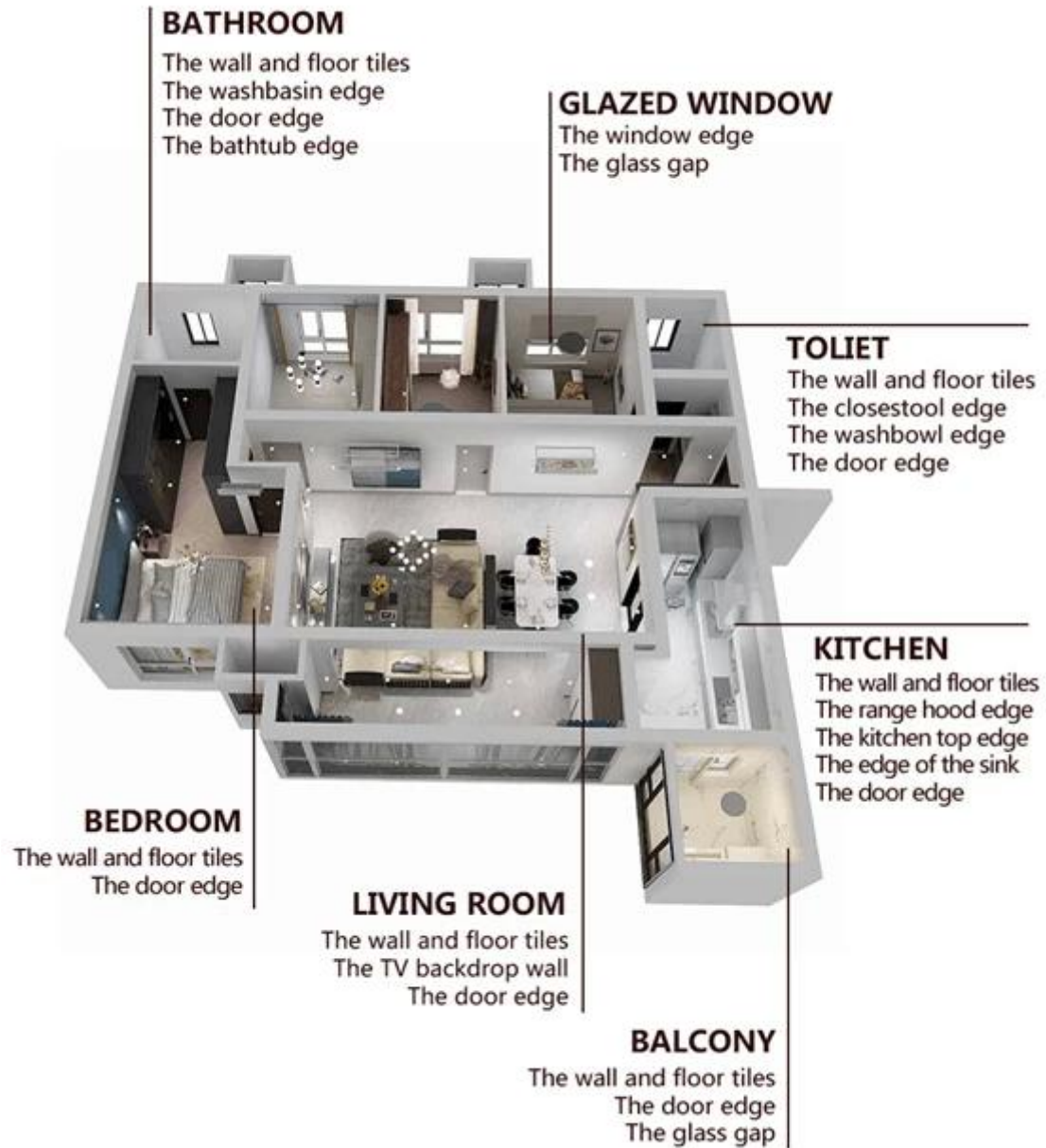

Brief Construction Process

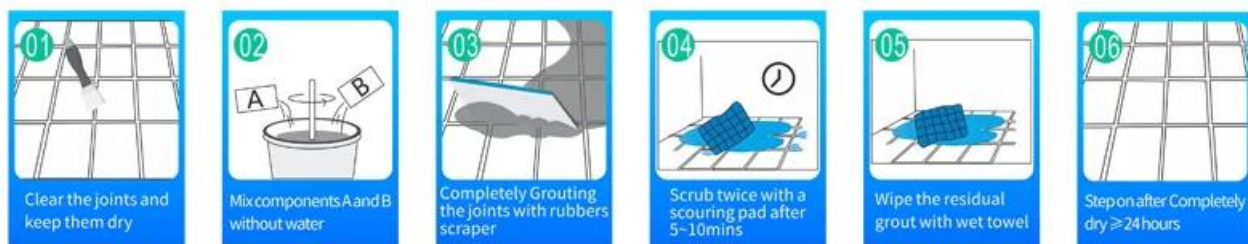

Professional Joint-Pressing Tool



Company Advantage

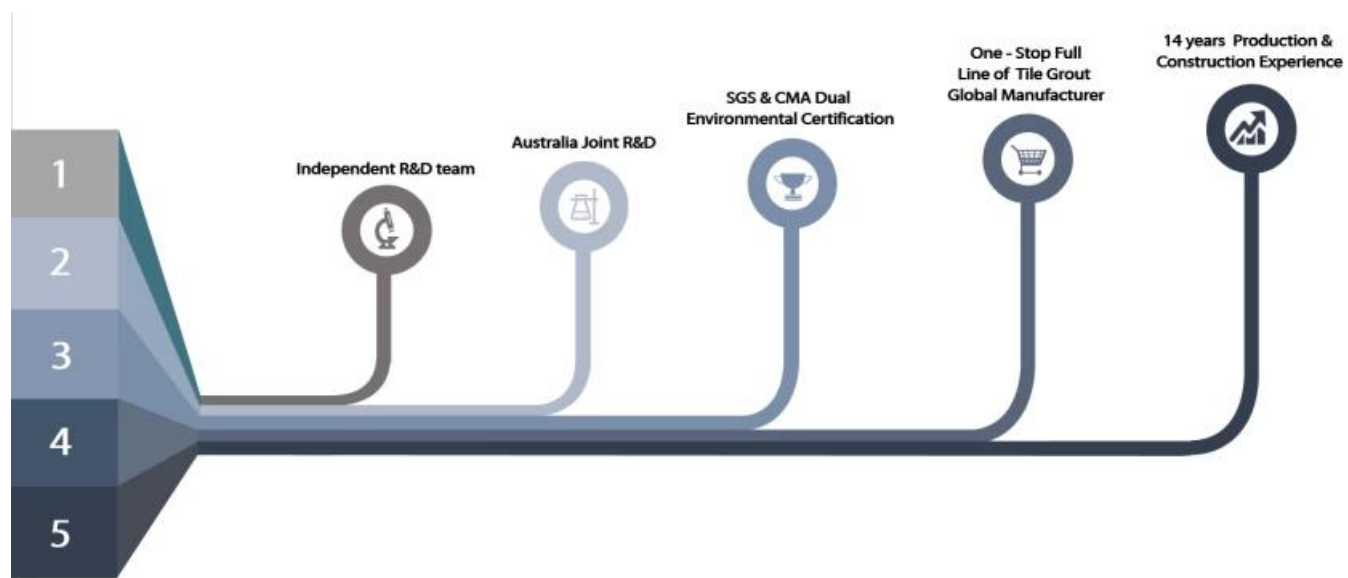

Factory Overview



Creaming Machine Line



Testing Machine



Batching Production Line



Cooling Filing



Filling Machine Line



Film-coated Machine



Real Material Stock



Stock

Certification

