

Kelin waterborne epoxy adhesive is a high-end environmental product. And we are a grout booster factory with strong comprehensive strength. Matte texture, provides you a low-key luxury decorative style, and the joint surface looks perfect fit to the ceramic tile. Varieties of colors, let your decoration place sparkling. The subbase course of waterborne epoxy resin makes the product absolutely environmental. Natural sand calcined at high temperature makes the color more natural and beautiful and never fades.

Main Ingredient	Epoxy resin, High-end color powder
Function	The filling and beautification of tile gap
Shelf Life	Stock in a cool and dry place at 0-37 °C for 24 months
Net Weight	3KG
Packing	Bucket

The product can be better used in the joints of ceramic tile, stone, glass, mosaic tile on the wall or floor in bathroom, kitchen, bedroom and so on. It is a preference product in family decoration, adding negative oxygen ion to purify air. Australia joint research and development products to make the better performance, and through the Chinese Academy of Sciences strategic quality control guidance, to make products' quality stable. [Kelin epoxy tile grout manufacturer](#) is trusted by cusumers.



Varieties of colors for your choice. Also provide custom colors.

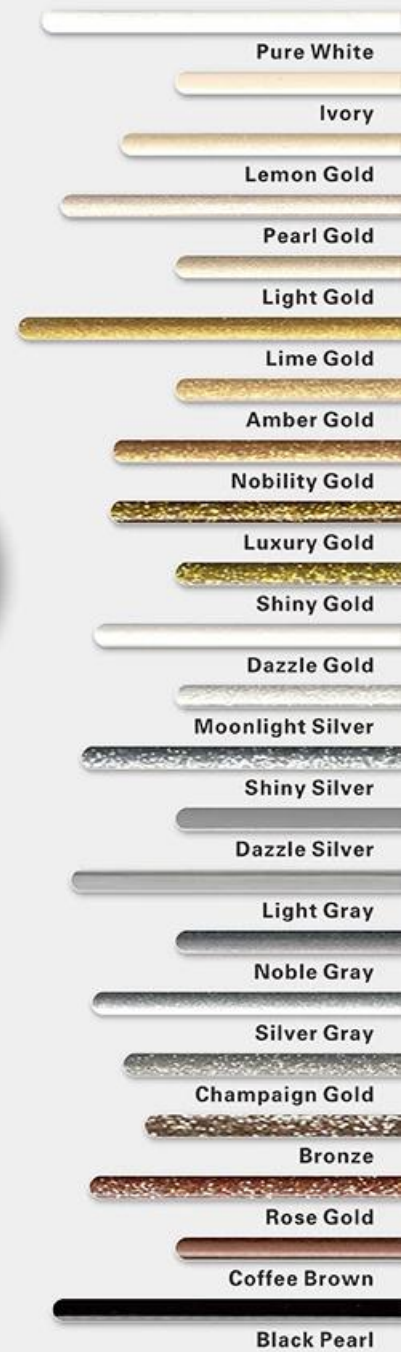

Provide Whole Room Gap Solution

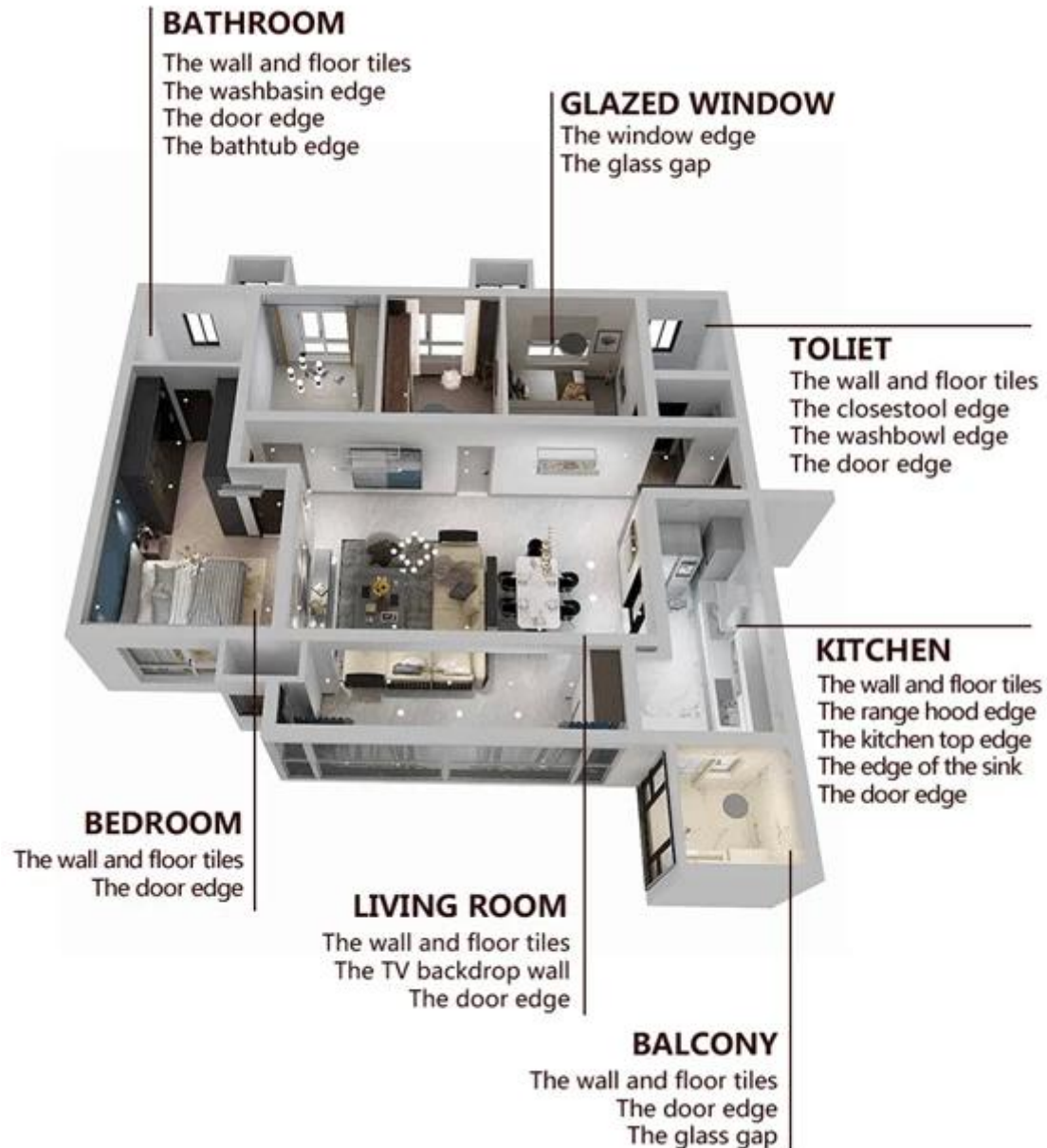

Brief Construction Process

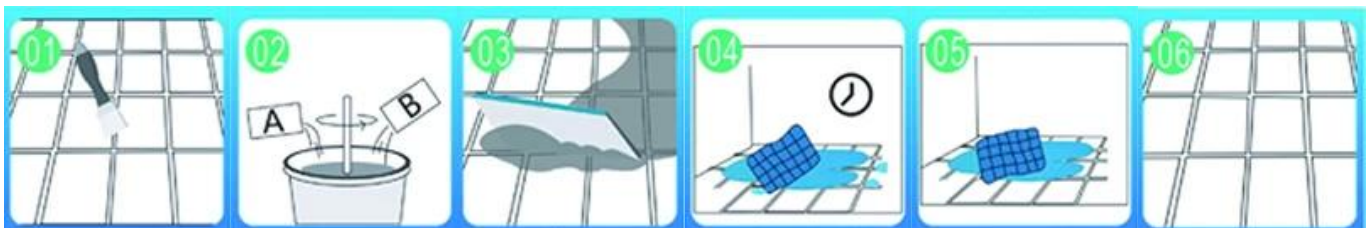

Clear the joints and keep them dry.

Mix components A and B without water.

Completely grouting the joints with rubber scraper.

Scrub twice with a scouring pad after 5-10mins.

Wipe the residual grout with wet towel.

Step on after completely dry ≥ 24 hours.

Professional Joint-Pressing Tool



Company Advantage

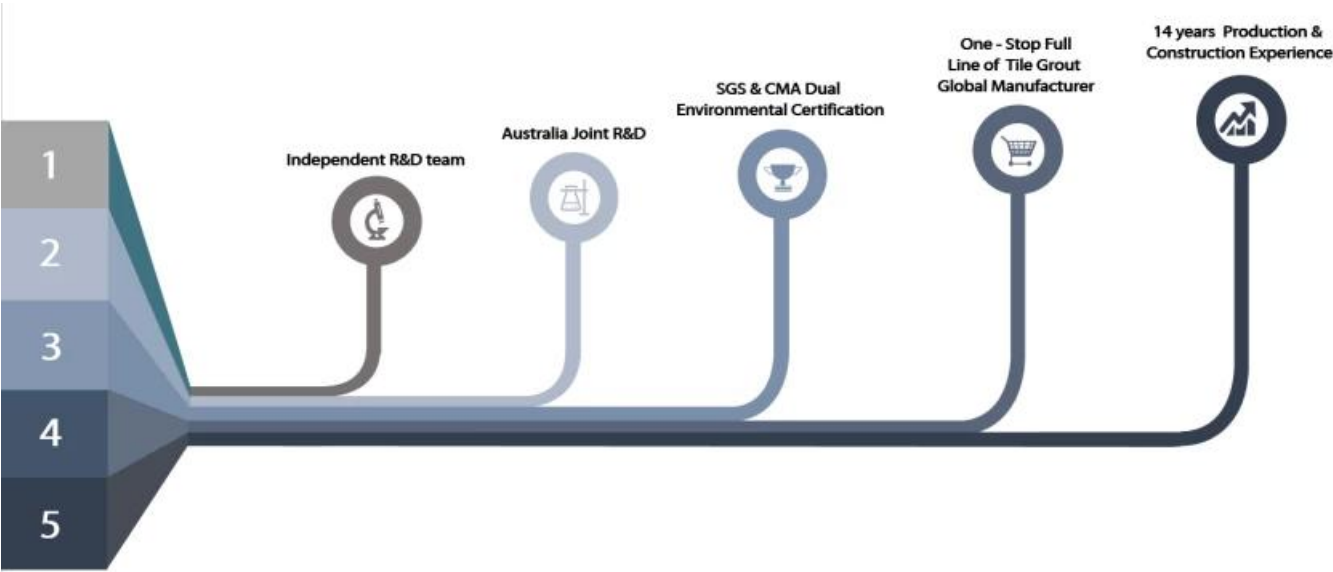

Factory Overview



Creaming Machine Line



Testing Machine



Batching Production Line



Cooling Filing



Filling Machine Line



Film-coated Machine



Real Material Stock



Stock

Certification

